

# AA POWER STATION

## Manual



**Please read the following safety and operating instructions carefully**

**Product No: AA1678**



Waste electrical products should not be disposed of with household waste. Please recycle with your local authority or retailer.

**Saxon**

Produces and distributes this product  
RG17 ODX | saxon-brands.com

**theAA.com**

Product no. AA1678

### **MOTORING ACCESSORIES**

Pictures are for illustration purposes only.  
Please retain for future reference.

The AA and the AA logo are registered trademarks of the Automobile Association Limited and are used under license. All rights reserved.

# POWER STATION

The AA Power Station is an ideal home accessory and an emergency power pack which can be used to jump start a battery, inflate tyres and illuminate an area when required.

This Power Station is suitable for starting 2.0L Petrol / 1.6L Diesel vehicles with overload and over charge protection. The Power Station contains with an air compressor which can be used to inflate tyres in an emergency.

The Power Station has an LED status indicator to show how much charge is left in the unit, plus a battery status indicator to give an instant view of available charge. It comes with an AC power supply for easy recharging providing up to 6 hours of DC power when 240V sockets are not available. It has a tough, durable case with a built in LED light for roadside emergency repair.

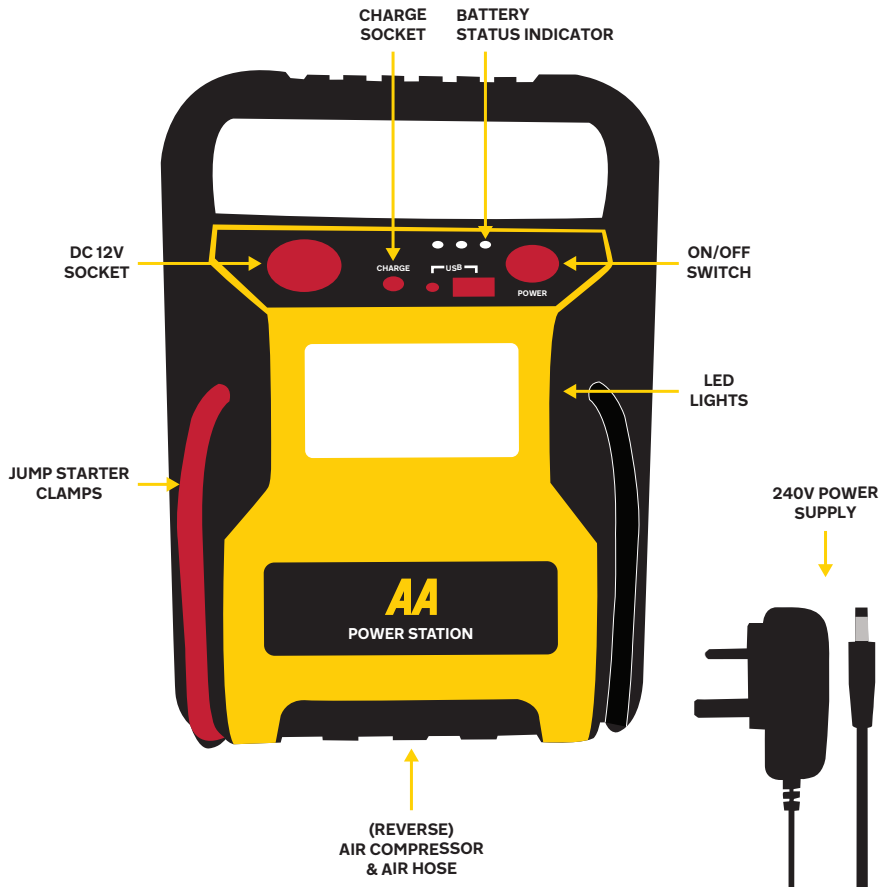

# TECHNICAL SPECIFICATIONS

## JUMP STARTER:

Suitable for vehicles	2.5 Petrol / 1.6 Diesel Note – extreme cold temperatures will affect the battery and product performance. If you operate in these conditions for any length of time, please consider using an alternative product
Battery	12V 10Ah lead acid battery. Maintenance free, including overload protection & reverse polarity indicator
Start/peaking current	250-600A

## AIR COMPRESSOR:

Maximum Pressure	150psi / 10 bar
Pressure Gauge	Selectable readings in PSI / BAR (Accurate to +/- 3 PSI)
Light	LED work light & flash light
Output	12V/15 Amp
USB	5V/2 Amp
Air hose length	60cm

**⚠ WARNING**  
**PLEASE READ INSTRUCTIONS CAREFULLY BEFORE USE.**  
**ALWAYS CHECK EQUIPMENT BEFORE USE. IF DAMAGED, DO NOT USE AND DISCARD.**  
**PLEASE RETAIN THESE INSTRUCTIONS FOR FUTURE REFERENCE**

This Power Station is designed for domestic use and for intended purpose only. It is not designed and is not fit for commercial, industrial or rental use.

This appliance is not intended for use by children or by persons with reduced physical, sensory or mental capabilities.

Read all instructions and warnings prior to using this product. Improper use of this product may result in product damage, excess heat, toxic fumes, fire or explosion, for which the manufacturer is not responsible.

## IMPORTANT SAFETY INFORMATION:

- Inspect the Power Station before each use, ensuring there is no damage to the components. Do not open the Power Station to replace the internal battery, there are no user-replaceable parts inside.
- Always check your vehicle's user manual before attempting to jump-start your vehicle to determine that on-board computers will not be damaged.
- Do not use on a broken or frozen battery.
- Do not submerge this appliance in water, or expose it to rain or moisture.
- Do not expose your Power Station to fire, intense heat, or flammable liquids.
- Keep away from and out of reach of children.
- Must only be used by a responsible adult.
- Do not insert foreign objects into ANY inputs or outputs.
- Do not use this product where there are flammable fumes, gases, or dust present.
- Connect this Jump Starter as per your vehicles manual.
- Do not expose to temperatures over +140°F (+60°C) or under -4°F (-20°C).
- Always disconnect the jump start cables from the Jump Starter after use and store as indicated.
- Never leave the Jump Starter/Air Compressor connected to the car battery unattended.
- Keep the power cord in good condition i.e. by avoiding extreme temperatures and not lifting using cord etc.
- Must be charged in a well ventilated environment.
- In case of an electrical or mechanical fault, immediately switch off and unplug the compressor.
- Do not bend or restrict the air hose whilst the compressor is in use.
- The compressor should not be used for more than 10 minutes at any one time. If using for extended periods give the compressor a 15 minute break allowing for it to cool between use.
- For safety reasons the compressor should not be left running unattended.
- Please refer to your vehicle handbook for the correct tyre pressure required for your vehicle.
- Only use on tyres and inflatable items taking care not to over inflate.
- Store in safe dry place when not in use.
- Only use with 12v lead acid batteries.
- Do not smoke, use matches or lighters near this equipment.
- Do not submerge in water.
- Keep clamps in storage compartment when not in use.
- Your Power Station must be disposed of properly at your local recycling facility when it is no longer able to be used.
- Warning plug may get warm during use.

**Please retain manual for future reference.**

**Saxon disclaims any liability for damage arising from misuse of this product.**

## USER GUIDE:

1. The Power Station and USB power can be turned on/off using the Power Switch.
2. Pressing the "ON/OFF BUTTON" will indicate the battery status of the Power Station. The unit will automatically turn off after 15 seconds of inactivity to conserve power.
3. A long press of the "ON/OFF BUTTON" will operate the LED light. Press it again to operate the flash setting and pressing for a further time will turn the LED lights off.

When the three lights are fully lit on the Battery Status Indicator the Power Station is fully charged. If only two lights are showing, the unit is at 50% of its maximum power. When one light remains or the lights are flashing, the unit needs to be fully re-charged. The lights will flash during charging and all 3 lights will remain on until the power supply is removed.

For maximum battery life, it is recommended that you keep the Power Station fully charged at all times. Once you have used the unit as a jump starter, please fully recharge the appliance. For each attempt at jump starting, an additional 4 hours is required to charge the internal battery. Do not attempt more than four restarts of the vehicle. If your vehicle doesn't start after four attempts, please seek alternative assistance.

## HOW TO CHARGE:

The internal battery should only be charged using the accessories provided.

1. Via mains power (240V), AC charger plug provided.
2. Via 12V power socket.
3. Unit should be fully charged and discharged every 4-6 months to maintain battery life.

## USING THE JUMP STARTER

The Jump Starter provides a current up to 600 amp to assist starting a car.

Check to ensure the following before connecting the booster cable clamps to the car battery:

- Ensure the ignition is off.
- Ensure all ancillary equipment (lighting, radio etc.) is switched off.
- Ensure the vehicle battery is rated at 12V and is not damaged in any way.
- Ensure the battery terminals are perfectly clean, the clamps are firm and perfectly secure.

Before using the Power Station to jump start your vehicle, please read and follow these instructions and consult your vehicle manual.

1. Identify the polarity of the battery terminals. The battery terminal is typically marked with a (+) symbol for the positive terminal and a (-) for the negative terminal.
2. Identify if you have a negative or positive grounded vehicle. This can be done by identifying which battery post (+ / -) is connected to the chassis.

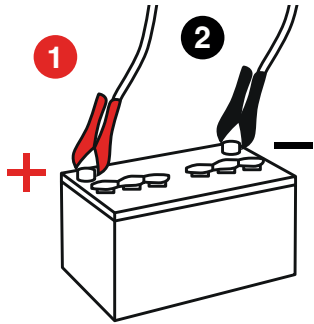

3. For a negative grounded vehicle (most common), connect the RED POSITIVE clamp first to the battery terminal, then connect the BLACK NEGATIVE clamp to the negative terminal or vehicle chassis. Note, when disconnecting, do so in reverse sequence, removing the negative first (or positive first for positive grounded systems).

4. Attempt to switch on the engine of the casualty vehicle.
5. Once the engine starts running, disconnect the black clamp " - " first and return it to its storage position. Then disconnect the red clamp " + " from the battery terminal and restore it to its storage position. Important: If your engine doesn't start, wait at least 3 minutes before trying again. Do not allow the positive and negative cables to touch during this process.

Re-charge your Power Station as soon as possible after using it as a jump starter.

## MAINTENANCE

To maintain the battery it is recommended to charge and discharge the battery on the unit at least once every 4-6 months. Failure to do this may reduce the battery life and result in the Power Station being unable to start the vehicle even if it appears fully charged.

## USING THE AIR COMPRESSOR

- Remove your tyre dust cap from the tyre valve.
- Carefully uncoil the air hose on the Power Station and attach to your vehicles tyres.
- Wait a few moments and your current air pressure will be displayed.
- Switch the "ON/OFF SWITCH" on the Power Station to "ON" and the compressor will automatically start to inflate.

### DO NOT USE CONTINUOUSLY FOR MORE THAN 10 MINUTES

- Once the desired pressure has been met, turn the "ON/OFF SWITCH" to "OFF", then disconnect the valve connection
- Replace any dust caps which have been removed

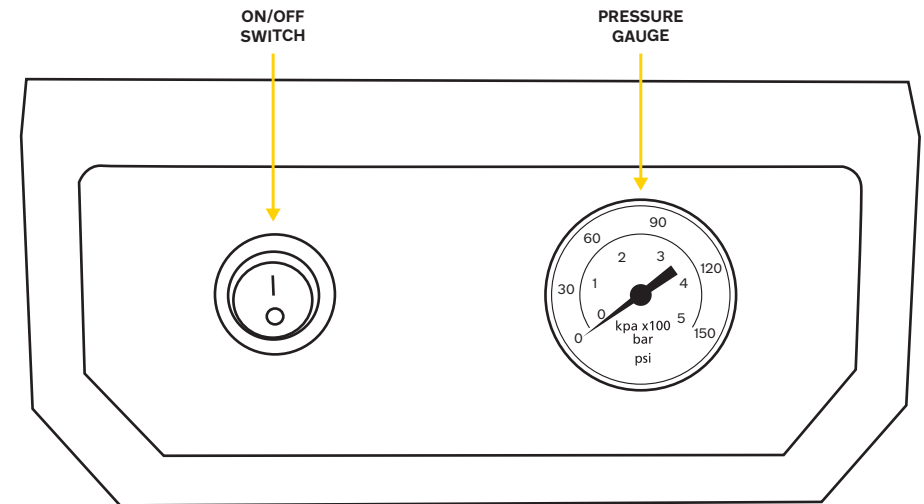

Air compressor on reverse of Power Station.

### WARNING

Air compressor is an auxiliary function and is not designed for use to inflate a vehicle tyre from flat, only to top up the tyre pressure.